

# S6400

2016-2019 NISSAN, TITAN, XD, Filter Back,  
4.0" Single Side

# MBRP®

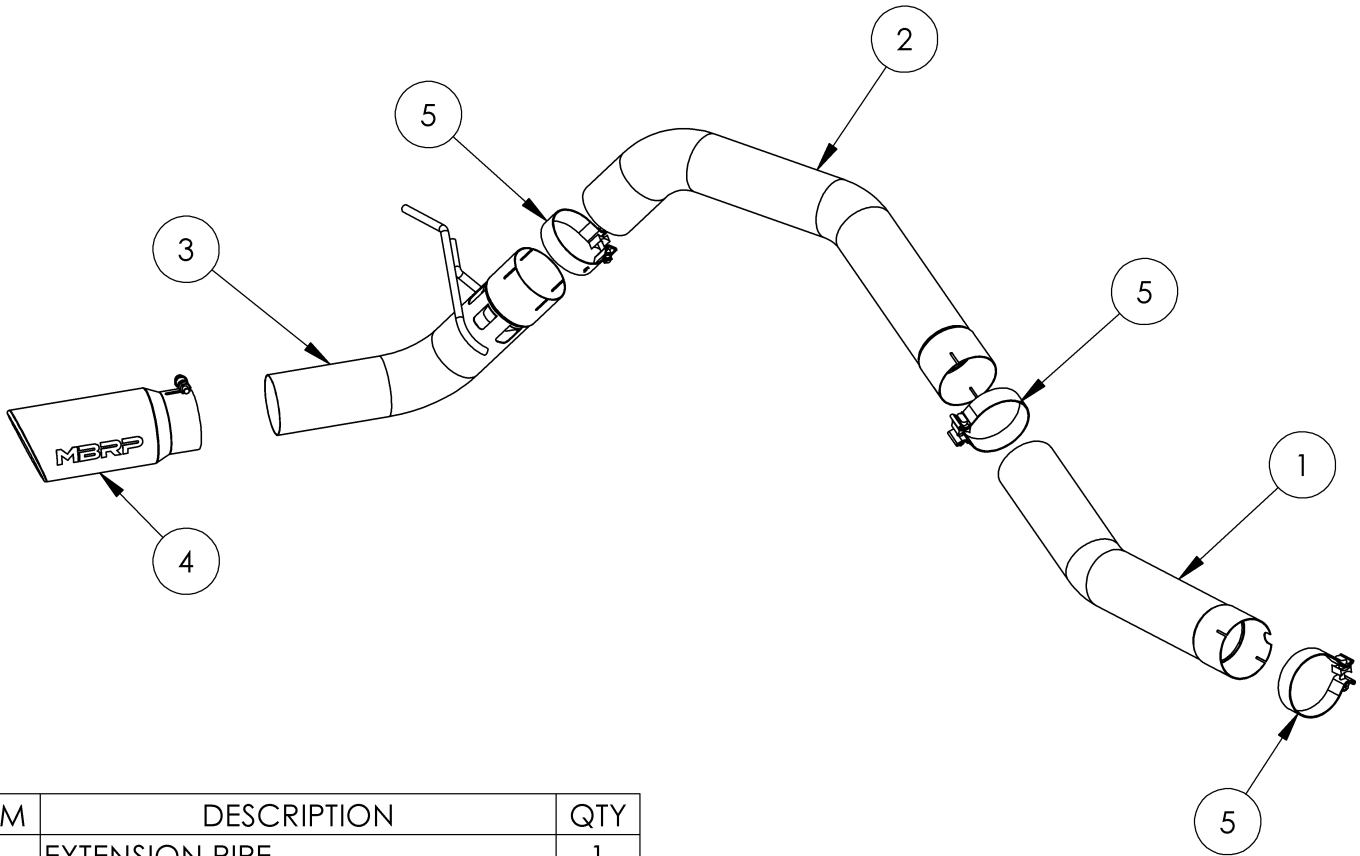

ITEM	DESCRIPTION	QTY
1	EXTENSION PIPE	1
2	OVER-AXLE PIPE	1
3	TAIL PIPE	1
4	EXHAUST TIP	1
5	4" BAND CLAMP	3

Refer to this LOT NUMBER when contacting customer service: \_\_\_\_\_

## PLEASE READ BEFORE STARTING INSTALLATION

While MBRP has made every effort to ensure that all components of this system are of superior quality and properly packaged, it is the installer's responsibility to ensure the following before removal of the factory exhaust:

- that ALL components shown above are present.
- that ALL mating components fit together.
- that there are no damaged components.
- that the system you have purchased is appropriate for your vehicle year, model and configuration.
- that the system will not interfere with any modifications previously installed or planned.
- that you have read and understand these instructions.

If you have any questions or are uncertain about any aspect of the installation of this system to your vehicle please contact your dealer before commencing installation.

# MBRP®

## Removal of Stock System:



Figure 1

1. Apply a penetrating lubricant liberally to all hangers and rubber isolators.
2. Loosen the factory over-axle pipe clamp at the rear of the DPF (Diesel Particulate Filter).  
**Refer to Figure 1.**



Figure 2

3. Remove the two bolts attaching the tail pipe rubber isolator and remove the factory system. Save the factory isolator and bolts for the installation.  
**Refer to Figure 2.**

## Installation of MBRP Performance Exhaust:

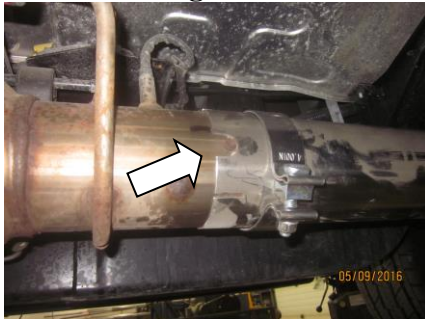

Figure 3

1. Along with a 4" **Clamp**, place the **Extension Pipe** onto the DPF outlet. Align the notch with the locator boss.  
**Refer to Figure 3.**



Figure 4

2. Using a 4" **Clamp** loosely install the **Over Axle Pipe** onto the **Extension Pipe**.
3. Using a 4" **Clamp** loosely install the **Tail Pipe** onto the **Over-Axle Pipe**.  
**Refer to Figure 4.**

4. Place the factory rubber isolator onto the **Tail Pipe** hanger and re-attach the isolator to the frame using the original bolts.  
**Refer to Figure 4.**



Figure 5

5. Install the **Exhaust Tip** and adjust to your liking.  
**Refer to Figure 5.**

6. Tighten all hardware and clamps, starting at the front and working rearward to secure the system. Check along the full length of the exhaust system to ensure there is adequate clearance for fuel lines, vent lines, brake lines, frame, bodywork, suspension, and any wiring, etc. If there is any interference detected, relocate, or adjust to provide adequate clearance. Ensure all clamp connections are secure and components are unable to rotate or slide. Band clamps require approximately 45 lb-ft (60 N-m) of torque. Verify clearances, system security and band clamp torque after 30-60 miles (50-100 km) of driving.

# MBRP®



**Congratulations!** You are ready to begin experiencing the improved power, sound and driving experience of your MBRP performance exhaust system. We know you will enjoy your purchase.