

# S5239

2019-UP FORD EDGE ST, 2.7L ECOBOOST V6,  
AXLE-BACK, 2.5", DUAL REAR

# MBRP®

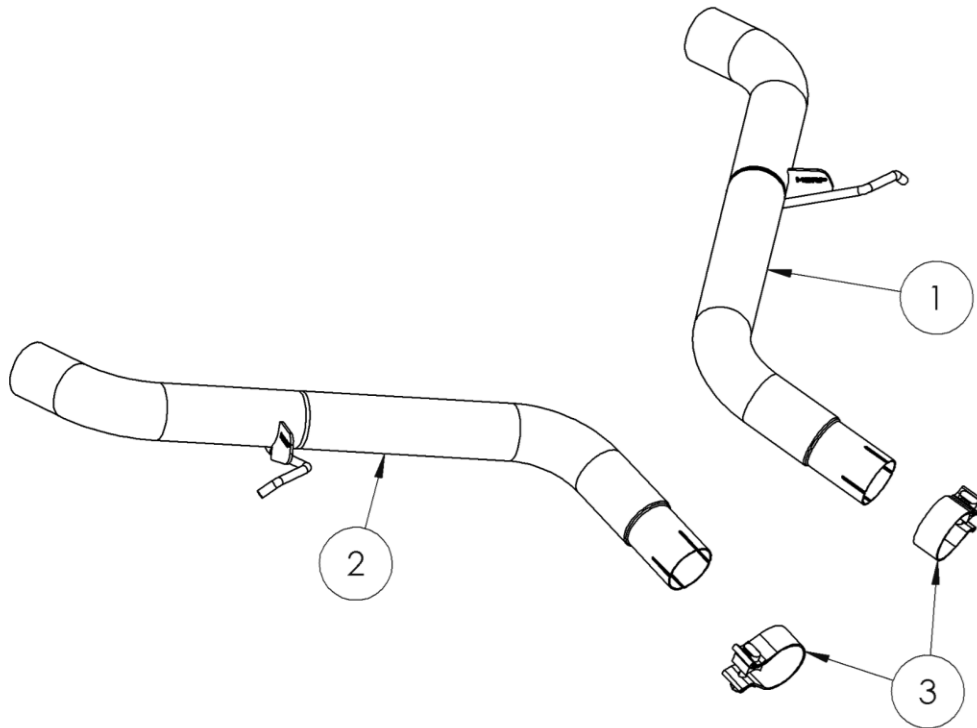

ITEM	DESCRIPTION	QTY
1	DRIVER-SIDE TAIL PIPE	1
2	PASSENGER-SIDE TAIL PIPE	1
3	2.17" CLAMP	2

## PLEASE READ BEFORE STARTING INSTALLATION

**While MBRP has made every effort to ensure that all components of this system are of superior quality and properly packaged, it is the installer's responsibility to ensure the following before removal of the factory exhaust:**

- that ALL components shown above are present.
- that ALL mating components fit together.
- that there are no damaged components.
- that the system you have purchased is appropriate for your vehicle year, model and configuration.
- that the system will not interfere with any modifications previously installed or planned.
- that you have read and understand these instructions.

If you have any questions or are uncertain about any aspect of the installation of this system to your vehicle please contact your dealer before commencing installation.

# MBRP

## Removal of Stock System



Figure 1



Figure 2



Figure 3

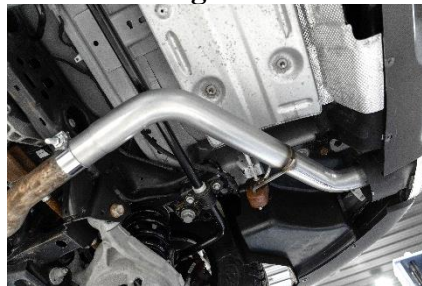

Figure 4

1. Apply penetrating lubricant liberally to all exhaust fasteners, hangers, and rubber insulators.
2. Measure 3.75" from the center of the sway bar towards the front of the vehicle and mark both pipes. Verify marks are just in front of the factory bend, then cut both pipes. The factory front pipe will need support to prevent it from falling.  
**Refer to Figure 1 & 2.**
3. Remove the factory rear muffler from the rubber insulators.

## Installation of **MBRP** Performance Exhaust

1. Slide a 2.17" **Clamp** onto each pipe, insert the **Drivers-Side Tail Pipe** into the factory bezel then onto the cut pipe and lastly into the factory rubber isolator. Repeat for passenger side.  
**Refer to Figure 3 & 4**
2. Carefully align the system. Align the edge of each band clamp with the edge of the joint it is connecting. Tighten all hardware and clamps, starting at the front and working rearward to secure the system. Check along the full length of the exhaust system to ensure there is adequate clearance for fuel lines, vent lines, brake lines, frame, bodywork, suspension and any wiring, etc. If there is any interference detected, relocate or adjust to provide adequate clearance. Ensure all clamp connections are secure and components are unable to rotate or slide. Band clamps require approximately 45 lb-ft (60 N-m) of torque. Verify clearances, system security and band clamp torque after 30-60 miles (50-100 km) of driving.



**Congratulations!** You are ready to begin experiencing the improved power, sound and driving experience of your **MBRP** Performance Exhaust.

We know you will enjoy your purchase!