

# S5156

2025-UP RAM 1500, 3.0L SST, SO,  
3.0" CAT-BACK, 2.5" DUAL SPLIT  
REAR

# MBRP®

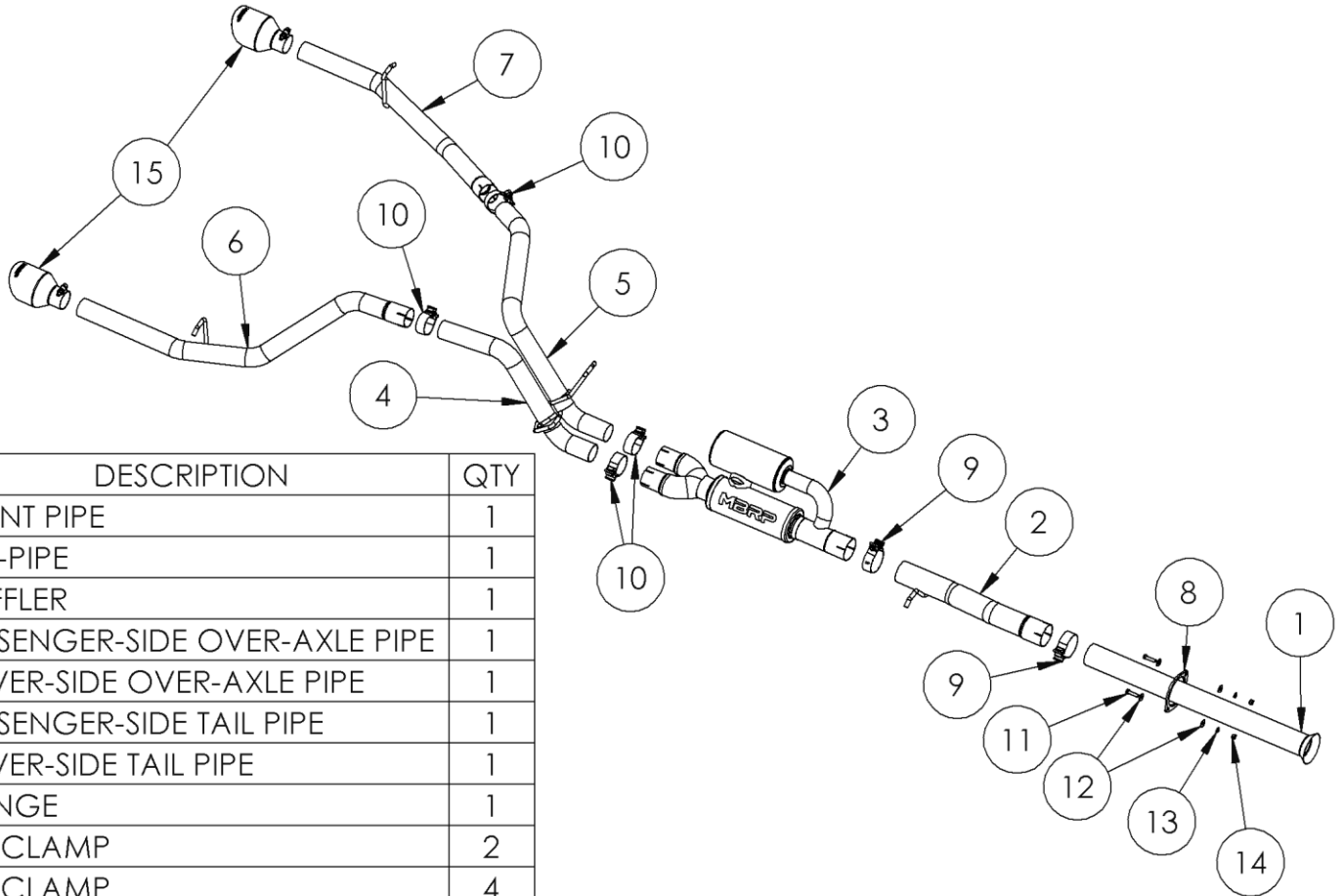

ITEM	DESCRIPTION	QTY
1	FRONT PIPE	1
2	MID-PIPE	1
3	MUFFLER	1
4	PASSENGER-SIDE OVER-AXLE PIPE	1
5	DRIVER-SIDE OVER-AXLE PIPE	1
6	PASSENGER-SIDE TAIL PIPE	1
7	DRIVER-SIDE TAIL PIPE	1
8	FLANGE	1
9	3.0" CLAMP	2
10	2.5" CLAMP	4
11	3/8" X 1.5" HEX BOLT	2
12	3/8" FLAT WASHER	4
13	3/8" LOCK WASHER	2
14	3/8" HEX NUT	2
15	TIP	2

Refer to this LOT NUMBER when contacting customer service: \_\_\_\_\_

## PLEASE READ BEFORE STARTING INSTALLATION

While MBRP has made every effort to ensure that all components of this system are of superior quality and properly packaged, it is the installer's responsibility to ensure the following before removal of the factory exhaust:

- that ALL components shown above are present.
- that ALL mating components fit together.
- that there are no damaged components.
- that the system you have purchased is appropriate for your vehicle year, model and configuration.
- that the system will not interfere with any modifications previously installed or planned.
- that you have read and understand these instructions.

If you have any questions or are uncertain about any aspect of the installation of this system to your vehicle please contact your dealer before commencing installation.

# MBRP

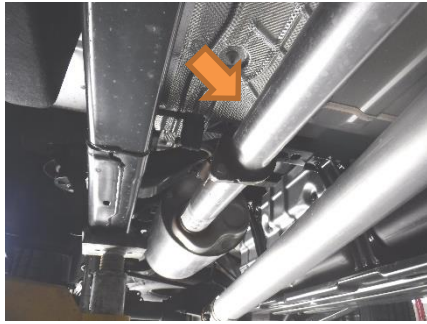

**Figure 1**



**Figure 2**

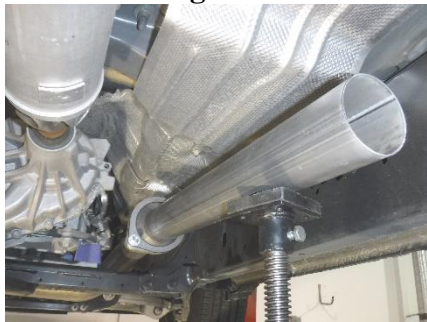

**Figure 4**



**Figure 5**



**Figure 6**

## Removal of Stock System

1. Apply penetrating lubricant liberally to all exhaust fasteners, hangers, and rubber isolators.
2. Remove both OEM tips from the truck.
3. Unbolt and remove the OEM front pipe assembly. **Refer to Figure 1.**
4. Loosen the passenger-side tailpipe clamp before removing the hanger from the rubber isolator. Remove the passenger-side tailpipe assembly.
5. Remove the driver-side upper sway bar link bolt and move the link to the side. The truck must be supported to allow the rear axle to droop and provide clearance for removal of the driver-side tailpipe/muffler assembly. **Refer to Figure 2.**
6. Remove the muffler assembly hangers from the four factory isolators. Remove the assembly from the truck.

## Installation of MBRP Performance Exhaust

1. Determine the length of the **Front Pipe** and cut to length. **Refer to Figure 3.**

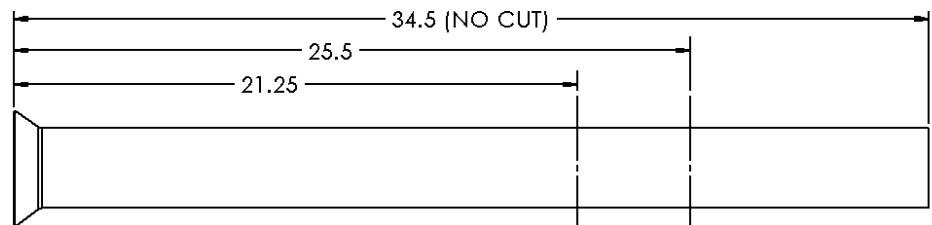

CAB TYPE	BOX LENGTH	WHEELBASE	FRONT PIPE LENGTH
QUAD CAB	6'4"	140.5"	21.25"
CREW CAB	5'7"	144.6"	25.5"
CREW CAB	6'4"	153.5"	34.5" (NO CUT)

**Figure 3**

2. Install the **Flange** onto the **Front Pipe**. Be sure the chamfer on the inside of the flange is facing the flare on the pipe.
3. Loosely install the **Front Pipe** using the provided **Hardware**. **Refer to Figure 4.**
4. Using a **3.0" Clamp**, loosely install the **Mid-Pipe** onto the **Front Pipe**. Insert the hanger into the rubber isolator on the truck. **Refer to Figure 5.**

# MBRP



Figure 7

5. Place a **3.0" Clamp** on the inlet of the **Muffler**, and a **2.5" Clamp** on each outlet. Loosely install the **Muffler** onto the **Mid-Pipe**.  
**Refer to Figure 6.**

6. Install the **Driver-Side Over-Axle Pipe** and **Passenger-Side Over-Axle Pipe** into the **Muffler** and into their respective rubber isolators.  
**Refer to Figure 7.**

7. Using a **2.5" Clamp**, loosely install the **Passenger-Side Tail Pipe** onto the **Passenger-Side Over-Axle Pipe**. Insert the hanger into the rubber isolator on the truck.  
**Refer to Figure 8.**



Figure 8

8. Using a **2.5" Clamp**, loosely install the **Driver-Side Tail Pipe** onto the **Driver-Side Over-Axle Pipe**. Insert the hanger into the rubber isolator on the truck.  
**Refer to Figure 9.**

9. Install the **Tips** and adjust to your preference.  
**Refer to Figure 10.**



Figure 9

10. Carefully align the system and tips. Align the edge of each band clamp with the edge of the joint it is connecting. Tighten all hardware and clamps, starting at the front and working rearward to secure the system. Check along the full length of the exhaust system to ensure there is adequate clearance for fuel lines, vent lines, brake lines, frame, bodywork, suspension and any wiring, etc. If there is any interference detected, relocate or adjust to provide adequate clearance. Ensure all clamp connections are secure and components are unable to rotate or slide. Band clamps require approximately 45 lb-ft (60 N-m) of torque. Verify clearances, system security and band clamp torque after 30-60 miles (50-100 km) of driving.



Figure 10



**Congratulations!** You are ready to begin experiencing the improved power, sound and driving experience of your **MBRP** Performance Exhaust. We know you will enjoy your purchase!