

S5014P

03-07 CHEV/GMC 1500 HD, 4.8L/5.3L EXTENDED CAB/CREW CAB-SHORT BOX, 3" SINGLE SIDE

MBRP
INC.
PERFORMANCE EXHAUST

19-Jul-18

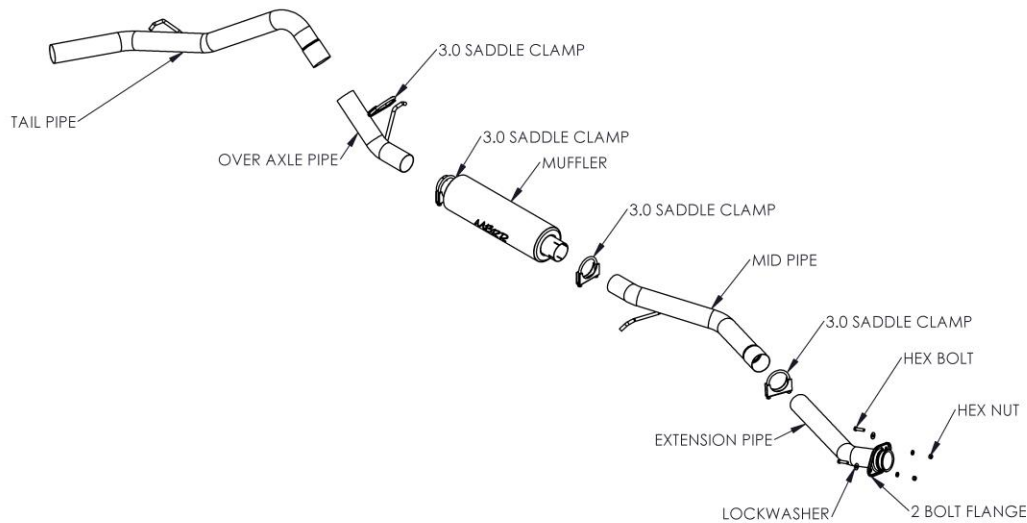

PLEASE READ BEFORE STARTING INSTALLATION

MBRP Inc. has made every effort to ensure that all components of this system are of superior quality and properly packaged. It is the installer's responsibility to ensure that all components are present and fit together as shown. Please also ensure that all components are undamaged before removal of the factory exhaust. Finally, check that this system properly matches the make and model of the vehicle and will not interfere with previous or planned modifications.

Removal of stock system:

1. Apply a penetrating lubricant liberally to all exhaust fasteners, hangers and rubber insulators.
2. Remove the nuts from the studs holding the front flange together and disconnect exhaust system.
3. Remove the hangers from the rubber insulators and remove the exhaust from the vehicle. If a hoist or hydraulic lift is not being used the tail pipe may need to be cut to clear the rear axle.
4. The studs located in the exhaust flange must be removed. This can be accomplished using a hammer. The studs will be replaced by the hardware supplied with the system.

Installation of MBRP Inc. Performance Exhaust:

1. Slide the **2 Bolt Flange** over the **Extension Pipe** and loosely attach the **Extension Pipe** at the flange using the hardware provided.
2. Using the **3" Clamp**, loosely attach the **Mid Pipe** to the **Extension Pipe** and attach hanger to rubber insulator located on the frame.
3. Using the **3" Clamp**, install the **Muffler** onto the **Mid Pipe**. With another **3" Clamp**, install the **Over Axle Pipe** into the opposite end of the **Muffler**. Insert the hanger into the factory rubber insulator located above the rear of the muffler.
4. Feed the **Tail Pipe** over the axle and loosely attach it to the **Over Axle Pipe** with a **3" Clamp**. Insert the **Tail Pipe** hanger into the factory rubber insulator located directly above the hanger.
5. Align the exhaust as required before tightening clamps.
6. Starting at the front of the exhaust, tighten all clamps and connections.
7. Check along the whole length of the exhaust system to ensure that there is adequate clearance around the spare tire, fuel and brake lines or any wiring. If any interference is detected, relocate or adjust.

Congratulations! You are ready to begin enjoying the improved performance and driving experience of your MBRP Inc. Performance Exhaust system. We hope you enjoy your purchase.