

### 2002 VOLKSWAGON JETTA / GOLF-GTI - 1.8L, TURBOCHARGED

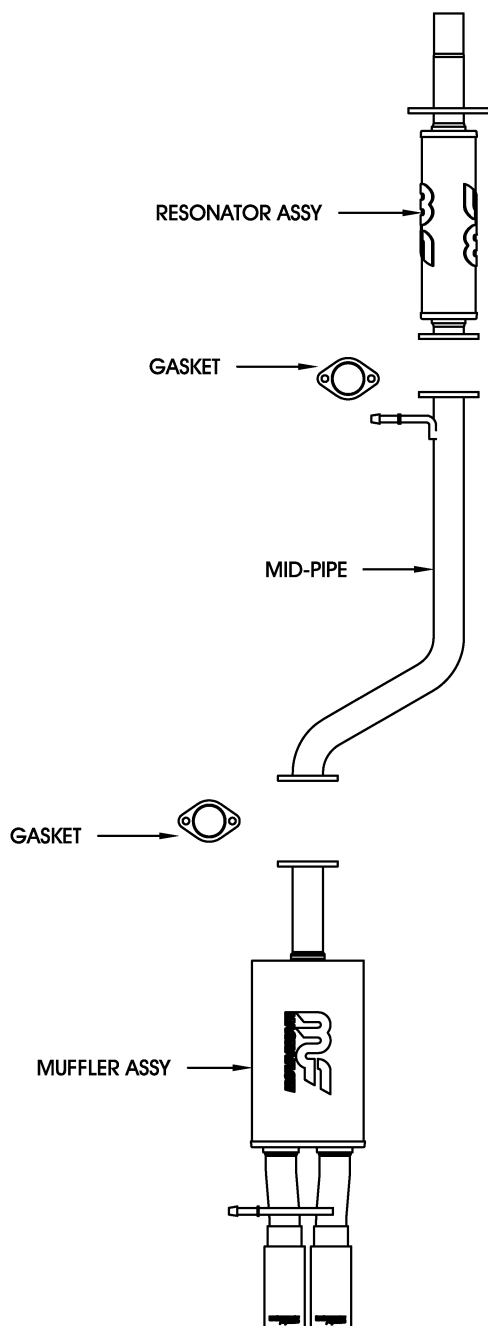

**Warning:** When working on under or around any vehicle exercise caution. Please allow the vehicle's exhaust system to cool before removal, as exhaust system temperatures may cause severe burns. If working without a lift, always consult vehicle manual for correct lifting specifications. Always wear safety glasses and ensure safe work area. Serious injury or death could occur if safety measures are not followed.

**Step 1:** (Carefully read all instructions before installation) If the OEM exhaust system is one piece, you will need to cut the tubing between the resonator and the torsion beam to remove the system from the vehicle. The tunnel crossmember will also need to be removed to extract the resonator. When removing the system from the vehicle, take care not to damage any of the OEM rubber insulators, and do not discard any OEM fasteners, as you may need to re-use them to mount the new system.

**Step 2:** Install the new resonator assembly by slip-fitting it to the catalytic converter extension using the OEM clamp assembly. Leave all fasteners loose for final adjustment of the complete system. Working rearward, install the new mid-pipe by fitting the welded hanger into the OEM rubber insulator on the crossmember. Re-install the tunnel crossmember with the mid-pipe and fasten the front 2-bolt flange of the mid-pipe to the resonator using the supplied gasket and fasteners. Fit the muffler hanger into the OEM rubber insulator and fasten it to the mid-pipe using the supplied gasket and fasteners.

**Step 3:** With all components mounted loosely, adjust the system for overall aesthetics and clearance of frame & bodywork. (MAGNAFLOW recommends at least 1/2" of clearance between the exhaust system and any body panels to prevent heat-related body damage or fire.)

**Step 4:** Once a final position has been chosen for the new system, evenly tighten all fasteners from front to rear. Inspect all fasteners after 25-50 miles of operation and retighten if necessary.

\*MAGNAFLOW Performance Exhaust recommends professional installation on all their products

Technical support: 1-800-959-9226 ext. 4500