



BX1928 Installation Instructions 1995-98 Dodge Stratus

Utilization of Blue Ox baseplates with any tow bar not approved by Automatic Equipment Mfg. Co. invalidates the limited warranty.

Installation of this baseplate requires removing the front bumper. Holes will be drilled in the vehicle's frame and the bumper molding will need to be cut.

1. Read the General Instruction Sheet included with this baseplate.
2. The front bumper needs to be removed to attach the baseplate to the metal cross frame and the lower cross frame. First unscrew the bottom rivets, if the screws of the rivet do not come out, use a narrow screwdriver and hammer to pop out the screw and the rivet. Remove the bolts in front of the front tires using a 10mm socket. There are three plastic rivets on the top of the bumper, use a flathead screwdriver to remove these. Now the bumper is ready to slide out.
3. On the right side of the radiator there is a bracket that fastens the power steering hoses to the frame of the car. With the baseplate package is an extension bracket (Item 7) and 1/4" bolt, washer and nut to lower the power steering hoses. The hoses need to be lowered so that the baseplate can fit.
4. The baseplate can now be bolted to the metal bumper. Find the cast iron weight bolted to the center of the frame, remove the two bolts that are beside the weight. With an assistant, hold the baseplate to the metal bumper. The center bracket of the baseplate needs to be aligned with the holes beside the weight. Bolt the center bracket to the frame of the car. This will position the baseplate so that holes can be marked and drilled. Use a 17/32" bit for the holes. With the holes drilled, the baseplate can be completely fastened to the car. Loosen the center bracket bolts so that the short wire nuts can be fit through existing holes of the frame for the outside brackets of the baseplate. Use Loctite Blue with every bolt and tighten all nuts.
5. The bumper and molding can now be replaced. Because of the braces of the baseplate extending out to the frame, the molding will need to be cut so that it can be bolted on again.
6. Install the tow bar and safety cables according to the instructions included in their packages.
7. Do not substitute other devices if the tow bar pin and clip are lost.
8. **DEALER OR INSTALLER: BE SURE OWNER RECEIVES THE INSTRUCTION SHEET.**

Automatic

Tools Required

3/4" Wrench
 5/8" Wrench
 13mm Wrench
 17/32" Bit
 7/16" Wrench

11/16" Wrench
 10mm Wrench
 15mm Wrench
 Drill

Loctite Red
 Flathead Screwdriver
 Philips Screwdriver
 Vice Grips

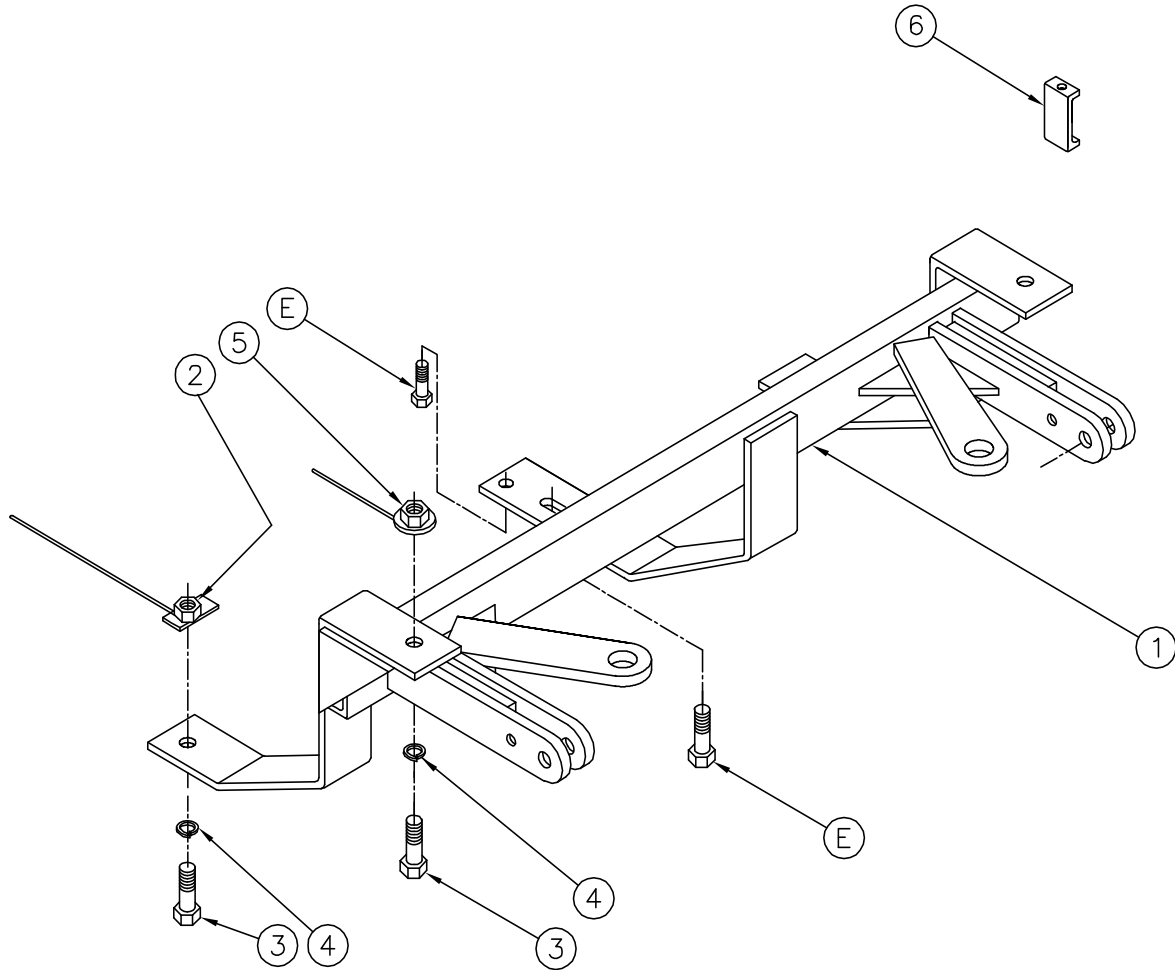

Parts List

| Ref. No. | Qty. | Part No. | Description |
|----------|------|----------|----------------------------------|
| 1 | 1 | 61-4930 | Weldment Baseplate, 1996 Stratus |
| 2 | 2 | 61-4931 | 1/2 Nut Plate, With 12" Wire |
| 3 | 4 | 201-0051 | 1/2-13 x 1/2 Hex Bolt Grd. 5 |
| 4 | 4 | 203-0012 | 1/2 Lock Washer |
| 5 | 2 | 61-4874 | Weldment , 1/2 Nut Wire |
| 6 | 1 | 102-5254 | Extension Bracket |
| 7 | 1 | 201-0569 | 1/4 Hex Bolt, Not Shown |
| 8 | 1 | 202-0102 | 1/4 Nut, Nylon Insert, Not Shown |
| 9 | 1 | 203-0001 | 1/4 Washer, Not Shown |
| E | | | Existing Hardware |

General Information

1. Ensure that your product(s) are registered online at www.blueox.com. It is crucial to register your product(s) so that you may be alerted of product offerings, updates, upgrades, maintenance and safety bulletins, and/or recalls.
2. **It is the owner's responsibility to inspect all towing equipment for cracked welds, missing or worn parts and loose bolts before each towing trip.** Be sure to use Loctite® Red on all bolts and tighten to the recommended specifications.
3. **It is the owner's responsibility to hook up all towing equipment per manufacturer's instructions/recommendations.**
4. Remove the attachment tabs when not in use (if applicable).

Notice To Baseplate Installer

1. It is YOUR responsibility to watch for:

- Oil cooler and air conditioner lines
- Electrical wires and hoses
- Missing parts or attaching points on the frame

** If the baseplate is improperly installed and is against a wire or hose, it could cause fluid leaks or electrical shorts some time after the actual baseplate installation.

Permanent Baseplate Safety Cable Installation

Permanent baseplate safety cables are strongly recommended when towing a vehicle with a tow bar. The principle function of the permanent baseplate safety cables is to prevent the towed vehicle from breaking loose in the event the connection between the frame of the towed vehicle and the baseplate fails or becomes disconnected. The cables must be connected from the baseplate to the frame rail or cross member of the vehicle's frame. The illustrations below show the possible arrangements recommended by Blue Ox®. Each permanent baseplate safety cable must have an adequate weight rating for the towing system. The weight rating of the two (2) cables together will not qualify.

Do not mount the permanent baseplate safety cables against wires, hoses or brake lines.

These permanent baseplate safety cables should remain installed as long as the baseplate is installed on the vehicle. Permanent baseplate safety cables are to be used in conjunction with, and NOT a replacement for legally required safety cables attaching the towed vehicle to the towing vehicle.

OPTION #1

Permanent Baseplate Safety Cables to Cross Member or Frame of Towed Vehicle.

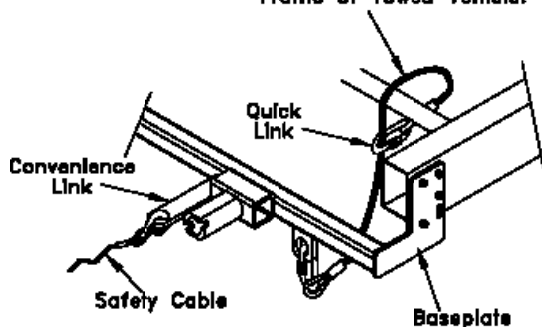

OPTION #2

Permanent Baseplate Safety Cables to Cross Member or Frame of Towed Vehicle.

